

# Little Traverse Bay Bands of Odawa Indians Points of Interest

Close up on  
Reverse Page

- 1** **Odawa Fishery Inc "Bell's", 0.48A**  
LTBB's fresh fish market. Also location of Tribal docking access in Lake Huron.
- 2** **Pond Street Parcels, 65.22A (3)**  
Large tract of wetlands designated as wild area that is open to Tribal hunting.
- 3** **King's Inn Parcels, 6.89A (4)**  
Former site of King's Inn Motel and the 3 adjoining wooded parcels. Site for future economic development.
- 4** **South of King's Parcels, 2.52A (2)**  
Two parcels between King's Inn Motel and the waterpark parking lot. Site for future economic development.
- 5** **Mackinaw Casino, 13.25A (5)**  
Site of new casino in Mackinaw City
- 6** **Wilderness Cabins, 1.36A**  
LTBB owned research station located in Wilderness State Park on Lake Michigan.
- 7** **St. James Bay Dock, 0.12A**  
Lk. Michigan waterfront property that provides Tribal docking access to Beaver Island.
- 8** **Wycamp Creek, 0.8A**  
Natural area located on Wycamp Creek
- 9** **Cross Village, 8.31A**  
Property located at the bottom of the bluff adjacent to boat launch in Cross Village.
- 10** **Ziibimijiwang, 311.74A (3)**  
"Place of the flowing river"  
Site for upcoming LTBB farming operation.
- 11** **Waawaashkesh, 76.84A**  
Wild area for Tribal member hunting. For more information contact the LTBB NRD.
- 12** **Drier Road/Fish Hatchery, 79.09A**  
Location of LTBB fish hatchery.
- 13** **Osborne Road East, 38.15A**  
Hunting available to Tribal citizens. For more information contact LTBB NRD.
- 14** **Osborne Road West, 38.27A**  
LTBB Traditional Jiingtamok-Ceremonial site. Closed to hunting.
- 15** **6108 Washington Pellston, 0.17A**  
Tribal rental home
- 16** **6521 Mill, Pellston, 0.36A**  
Tribal rental home
- 17** **WAH-WAHS-NOO DA KE, 80.92A**  
Tribal housing community for citizens and their families. For more information contact the LTBB Housing Dept.
- 18** **Administration Building, 96.68A**  
Offices for governmental operations, Tribal Administration, Tribal Chairman and departmental programs.
- 19** **Native Way, Lease**  
Tribal exercise facility available to Tribal citizens, employees, and their families.
- 20** **Biindigen Gas Station, 3.54A (2)**  
Offers fuel, tobacco and convenience products to Tribal citizens and the community.
- 21** **Second Street Property, 1.55A (7)**  
5 Parcels in Harbor Spring's "Indian Town" on the southside of Second Street.
- 22** **White House Building, 1.13A**  
Holds offices of the Departments of GIS, Planning, Communications and Commerce.
- 23** **Kishigo/Wall Parcel, 1.73A**  
Parcel of land on M-119 adjacent to Indian Hills Gallery and bike path.
- 24** **Monroe St. Daycare, 0.33A**  
Former daycare center purchased in 2012

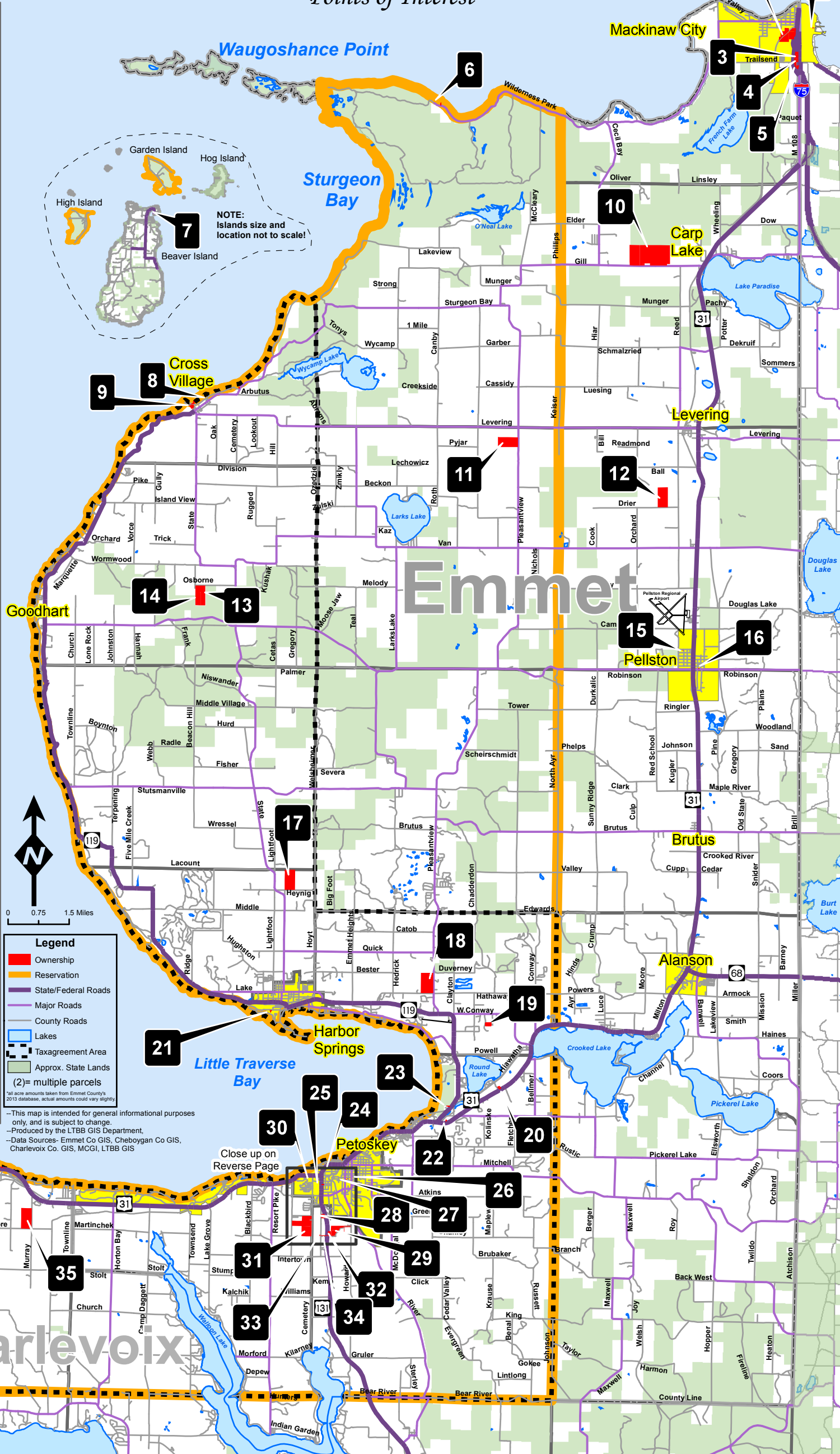

**Legend**

- Ownership
- Reservation
- State/Federal Roads
- Major Roads
- County Roads
- Lakes
- Taxagreement Area
- Approx. State Lands

(2)= multiple parcels

\*All acre amounts taken from Emmet County's 2013 database, actual amounts could vary slightly.

-This map is intended for general informational purposes only, and is subject to change.  
-Produced by the LTBB GIS Department.  
-Data Sources- Emmet Co GIS, Cheboygan Co GIS, Charlevoix Co. GIS, MCGI, LTBB GIS

- 25** **911 Spring Street, 0.96A**  
LTBB offices of LTBB Tribal Court, Prosecutor, Police, Human Services
- 26** **910 Petoskey Street, 0.18A**  
Tribal rental housing.
- 27** **915 Emmet Street, 0.17A**  
Youth Services Location. After school and summer programs for the youth.
- 28** **Odawa Hotel, 6.69A**  
Owned and operated by LTBB. First class lodging, dining, and conference facilities to the Northern Michigan community and beyond.
- 29** **Bear River Health Park, 8.27A**  
Home of all health and therapeutic services for the Tribal community.

- 30** **Commodities, Lease**  
Food Distribution location. Back side of Fletches building. Call Human Services for more information, 231-242-1620.
- 31** **Odawa Casino, 95.89A(2)**  
Owned and operated by LTBB. Provides a wide variety of gaming, entertainment and dining options for Northern Michigan.
- 32** **Victories Property, 30.03A (2)**  
Site for new ODEMI development.
- 33** **Lears 2 Parcels, 2.59A**  
Property along Lears Road.
- 34** **Lears1/Signage Parcel, 0.4A**  
Parcel west of Anderson Road for signs.

- 35** **Murray Road Property, 83.52A**  
New energy efficient Tribal housing complex. Call the Housing Department for more information.
- 36** **Nine Mile Point Property, 1.42A**  
Provides an access point to Little Traverse Bay and Lake Michigan for Tribal Citizens.
- 37** **Taimi Hoag Nature Preserve, 57.17A(3)**  
3 parcels totaling 57 acres that encompass a nature preserve and nature trail that is adjacent to a Little Traverse Conservancy preserve. Open to Tribal hunting.
- 38** **St. Martin's Island Parcels, 51.47A (2)**  
Land used for fishing safe harbor and Tribal research. Located approx 23 miles from SE of Escanaba in Lake Michigan. \*Not displayed on this map.